



## **SAR9 SERIES** **SEMI-AUTOMATIC PISTOL**

**OWNER'S MANUAL**  
**MAINTENANCE & SPARE PARTS LIST**

## MODEL

- SAR 9
- SAR 9T
- SAR 9X
- SAR 9C
- SAR 9CX
- SAR 9 SOCOM
- SAR 9 SPORT
- SAR 9 METE
- SAR 9T METE

## SUB MODEL

- (9x19 mm) (With Safety Lever)
- (9x19 mm) (Without Safety Lever)
- (9x19 mm) (With Cooling Channel)
- (9x19 mm) (Compact)
- (9x19 mm) (Without Safety Lever, With Cooling Channel)
- (9x19 mm) (With Suppressor / Silencer Connection)
- (9x19 mm) (Full Size With Cooling Channel)
- (9x19 mm) (With Safety Lever)
- (9x19 mm) (Without Safety Lever)

Semi-Automatic Pistol

### **WARNING!**

SAR disclaims all liability arising out of the use of any SAR products (i) contrary to instructions or regulations; (ii) without caution; (iii) by any parties other than the license holder; (iv) through making unauthorized or illegal modifications thereon; (v) using non-standard or out of spec cartridges; (vi) under maintenance or repair services rendered by unauthorized persons; or (vii) under any similar conditions whatsoever. SAR excludes all liability for any injuries and/or property damages arising from the malicious or negligent use of the products.

### **WARNING!**

Safety is only activated when striker is cocked. Do not try to change the position to safe if not cocked. Forcing the safety into position while not cocked can cause damage which in turn will void the warranty.

### **WARNING!**

All illustrations and definitions in this Manual are provided for information purposes only. The manufacturer reserves the right to apply any changes to any models at any time without prior notice, as deemed necessary for product improvement or in line with any manufacturing or commercial requirements.

## CONTENTS

1. GENERAL PRECAUTIONS	5
2. GENERAL RULES FOR SAFETY	6
2.7. USE PROPER AMMUNITION	7
2.20.1. ACCESSORIES and TOOLS	9
2.20.2. ACCESSORIES	9
2.22. ADDITIONAL FEATURES	10
2.4. BASIC PARTS	12
2.4.2. SAR9 X - SAR9 CX - SAR9 SPORT	13
2.4.3. SAR9 SOCOM	14
2.5. TECHNICAL DATA & FEATURES	15
3. PUTTING YOUR PRODUCT INTO SERVICE	17
3.4. FIRING	18
3.4.2. LOADING YOUR MAGAZINE	19
3.4.3. ASSEMBLING YOUR FIREARM	19
3.4.4. SETTING YOUR LINE OF FIRE	20
3.4.6. RELOADING YOUR FIREARM	21
3.5. SECURING YOUR FIREARM	22
4.2. DISASSEMBLING YOUR FIREARM	23
4.3. MAINTENANCE AND CLEANING OF YOUR FIREARM	24
4.4. ASSEMBLING YOUR FIREARM	28
4.5. FUNCTION CHECK	29
4.6. MAINTENANCE OF YOUR MAGAZINE	30
4.6.1. DISASSEMBLING YOUR MAGAZINE	30
4.6.2. CLEANING YOUR MAGAZINE	31
4.7. BACK STRAP AND SIDE PLATES DISASSEMBLY	32
4.8. REMOVING SAFETY CORD RING and MAGWELL (SAR9 SOCOM)	33
4.9. SILENCER THREAD PROTECTOR DISASSEMBLY AND ASSEMBLY (SAR 9 SOCOM)	34
5. TROUBLESHOOTING	35
6. EXPLODED VIEW and PART LIST	36
6.2. SAR9 X EXPLODED WIEV	39
6.3. SAR9 C EXPLODED WIEV	41
6.4. SAR9 CX EXPLODED WIEV	43
6.5. SAR9 SPORT EXPLODED WIEV	45
6.6. SAR9 SPORT EXPLODED WIEV	47
6.7. SAR9 SOCOM EXPLODED WIEV	49



## 1. GENERAL PRECAUTIONS

Read the instructions and warnings in this manual carefully before handling SARSILMAZ products for any purposes. As a prerequisite for SARSILMAZ products you must be familiar with and follow the information provided in this manual. Please read the instructions thoroughly and carefully before handling the firearm. If you need any further information, please consult your dealer or the factory.

Please observe the laws of your state and/or your country governing the purchasing, handling, and use of firearms.

All firearms can be dangerous if not handled properly. Therefore, your product is sold to you provided that you comply with all instructions for use. SARSILMAZ disclaims in advance any and all responsibility for any technical damage and/or other consequences whatsoever that may be caused by; the misuse of the product, including any property damage or injury/death arising in relation to the following;

- Always keep the muzzle pointed in a safe direction.
- Firearms should be unloaded and secured when not in use.
- Do not rely on your firearm's safety.
- Be sure of your target and what's beyond it.
- Make sure that your ammunition matches the caliber or gauge of your gun.
- If your pistol fails to fire when the trigger is pulled, keep muzzle pointed in a safe direction for at least 10 seconds, if round does not fire, rack slide to eject faulty cartridge. Once ejected continue firing.
- It is your responsibility to ensure that you are in compliance with all applicable laws and ordinances regarding the use of your firearm.
- Other factors directly or indirectly of beyond our control.

## 2. GENERAL RULES FOR SAFETY

### 2.1. ALWAYS KEEP YOUR FIREARM POINTED IN A SAFE DIRECTION

Never point a firearm at yourself or anyone. This is particularly important when loading or unloading the firearm. Always be aware of what is behind your target. If you miss or hit your target, it is your responsibility to ensure your shot will not cause unexpected injuries or damages.

### 2.2. ALWAYS TREAT EVERY FIREARM AS IF IT IS LOADED

Do not take anyone's word that the firearm is unloaded always check for yourself. Assume your firearm is ready to fire unless you have visually checked that the firearm is unloaded.

### 2.3. HIDE YOUR GUN OUT OF CHILDREN'S SIGHT

It is your responsibility that your firearm is not accessible to children and other unauthorized persons. It is highly recommended that you store your firearm, unloaded and secured with ammunition stored separately. This will ensure minimizing the risk of accidents involving children and unauthorized persons.

### 2.4. NEVER SHOOT AT HARD SURFACES OR WATER

Shooting at water or hard surfaces can cause changes in the bullet's direction, which may cause injuries of your own, others, and/or property damage.

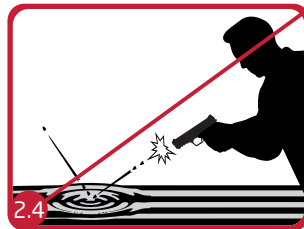
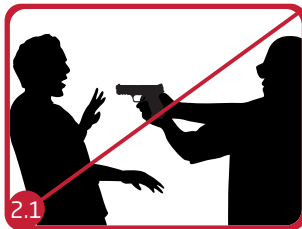

## **2.5. NEVER USE ALCOHOL OR DRUGS THAT MAY IMPAIR MENTAL OR PHYSICAL ABILITY WHILE SHOOTING/ HANDLING FIREARM**

Do not use your firearm if you are impaired by alcohol, drugs, and/or medications that will hinder your physical and mental abilities.

## **2.6. FOLLOW PROPER MAINTENANCE PROCEDURES FOR YOUR FIREARM**

In order to prevent accumulation of dirt or dust on operating parts, store your firearm in its original case once properly cleaned. Lubricate and clean your firearm after every use following the instructions in order to avoid any corrosion, barrel damage, and dirt. Before loading the barrel, always check to see if it is completely clean (completely free from any obstructions such as dirt, mud, oil, ammunition or ammunition residuals). Shooting against an obstruction can cause an increase in pressure and may damage your firearm and cause injury to yourself and others. If the operation of your firearm has changed the way it sounds, stop firing, make sure the firearm is pointed in a safe direction, and unload the firearm. Check the chamber and barrel bore for any failure. Using incorrect types or calibres of ammunition may cause the firearm to jam.

## **2.7. USE PROPER AMMUNITION**

Only use factory-loaded ammunition that is newly manufactured within industrial specifications. Ensure all cartridges used are compatible with the caliber and type of your firearm. Avoid using MP5 bullets!

## **2.8. ALWAYS WEAR SAFETY GLASSES AND EAR PROTECTORS SPECIFIED FOR FIREARM USE**

A shooter should always wear impact-resistant safety glasses and ear protectors when using any firearms to prevent hearing and sight damage.

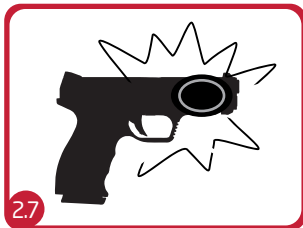

## 2.9. OBSERVE THE RULES

Observe all local and general rules regarding the handling, use and transportation of firearms.

### 2.10. ENSURE THAT YOU HAVE A FULL UNDERSTANDING OF THE SAFETY FEATURES OF YOUR FIREARM

Never rely on only the safety to prevent accidents. It is your obligation to make yourself familiar with and use the safety features of your firearm. The best way to prevent accidents is to follow the rules for safety and safe handling procedures defined in the product manual.

**2.11. NEVER ALLOW A FIREARM TO BE USED BY INDIVIDUALS THAT DO NOT UNDERSTAND ITS SAFE OPERATION OR HAVE NOT READ THESE FIREARM SAFETY RULES.**

**2.12. NEVER LEAVE A FIREARM UNATTENDED AND IN REACH OF AN UNAUTHORIZED PERSON. THIS MAY RESULT IN THEFT OR MAY EVEN POSE A THREAT TO OTHERS, CAUSING DAMAGE OR EVEN DEATH. ALL RESPONSIBILITY WILL BE YOURS.**

**2.13. IT IS IMPERATIVE THAT YOU KEEP YOUR FIREARM UNLOADED IN A SAFE AND SECURED LOCATION**

**2.14. NEVER ATTEMPT TO REMOVE AN OBSTRUCTED PROJECTILE IN THE BARREL BORE THROUGH FIRING ANOTHER ONE. UNLOAD FIREARM AND SEEK A QUALIFIED GUNSMITH**

**2.15. MAKE SURE YOU ARE FAMILIAR WITH THE OPERATIONS BEFORE USING AND LOADING THE FIREARM**

**2.16. ALLOW ONLY AUTHORIZED/QUALIFIED GUNSMITHS TO UNDERTAKE REPAIR PROCEDURES.**

**2.17. IT IS BOTH DANGEROUS AND FORBIDDEN TO MAKE MECHANICAL MODIFICATIONS ON ANY PART OF THE FIREARM. PLEASE NOTE THAT ANY PRODUCTS TREATED THIS WAY WILL EXCLUDE THE ENTIRE FIREARM FROM WARRANTY**

**2.18. USER OF THE FIREARM SHOULD STAND AT A REASONABLE DISTANCE FROM OTHER PERSONS**

**2.19. AVOID SQUEEZING THE TRIGGER IN EXCESS**

**2.20. IN THIS MANUAL, WARNINGS ARE LABELLED " ⚠ "**

### 2.20.1.ACCESSORIES and TOOLS

#### 2.20.2.ACCESSORIES

**Note:** Optional accessories below are not shipped with the firearm. Please contact SARSILMAZ for further questions on available accessories.

- Flashlight
- Tritium lighted rear sight
- Tritium lighted front sight
- Adjustable rear sight (windage and elevation)
- Adjustable front sight (elevation)
- Laser pointer
- Holographic sight

### 2.21. MAIN PRODUCT FEATURES

SARSILMAZ firearms are being manufactured from years of experience from producing firearms for shooting sports, police and military services requiring state-of-the-art technology. These pistol have a working mechanical lock system with semi-automatic system with a single action firing feature. Thanks to an automatic ring pin safety and trigger safety, you can carry it safely. With a comfortable ergonomics design the pistol has a visual indicator to let the user know when it is cocked and ready to be fired. (Depending on the model)

**\*\*\*\*\*Use life of our products is 10 (ten) years.**

## 2.22. ADDITIONAL FEATURES

SARSILMAZ semi-automatic pistols were specifically designed for law enforcement & military needs. SAR is the clear choice due to their extraordinary performance making SARSILMAZ semi-automatic pistols the preferred choice of law enforcement & military partners around the world.

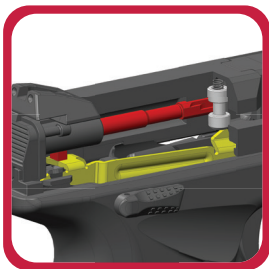

Firing Pin Safety

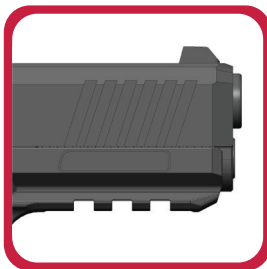

Picatinny Rail



Striker Status Indicator

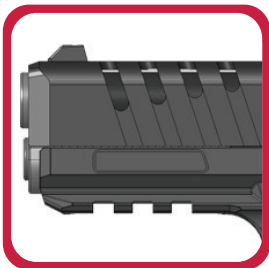

Cooling Channel

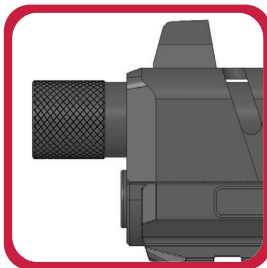

Muffler Thread Guard  
SAR9 SOCOM

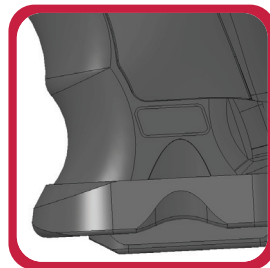

Mag Well  
SAR9 SOCOM



3 Interchangeable Side  
Panels and Back Straps.



Complete with  
Ambidextrous  
Safety

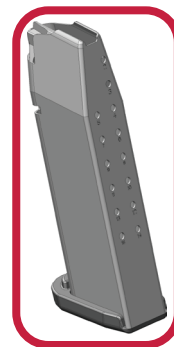

Steel Magazine

## 2.4. BASIC PARTS

### 2.4.1. SAR9 - SAR9 METE - SAR9 C - SAR9 T - SAR9 T METE

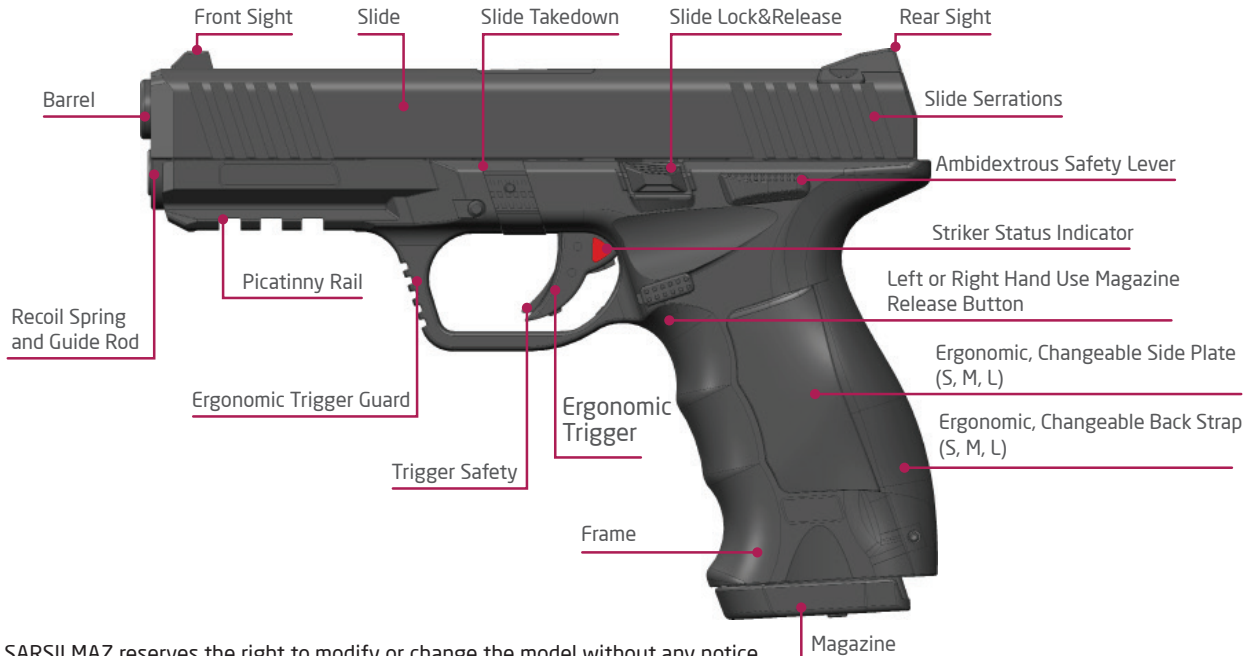

**Note:** SARSILMAZ reserves the right to modify or change the model without any notice.  
There isn't a safety lever on SAR9, SAR9 T METE AND SAR9 C



## 2.4.2. SAR9 X - SAR9 CX - SAR9 SPORT

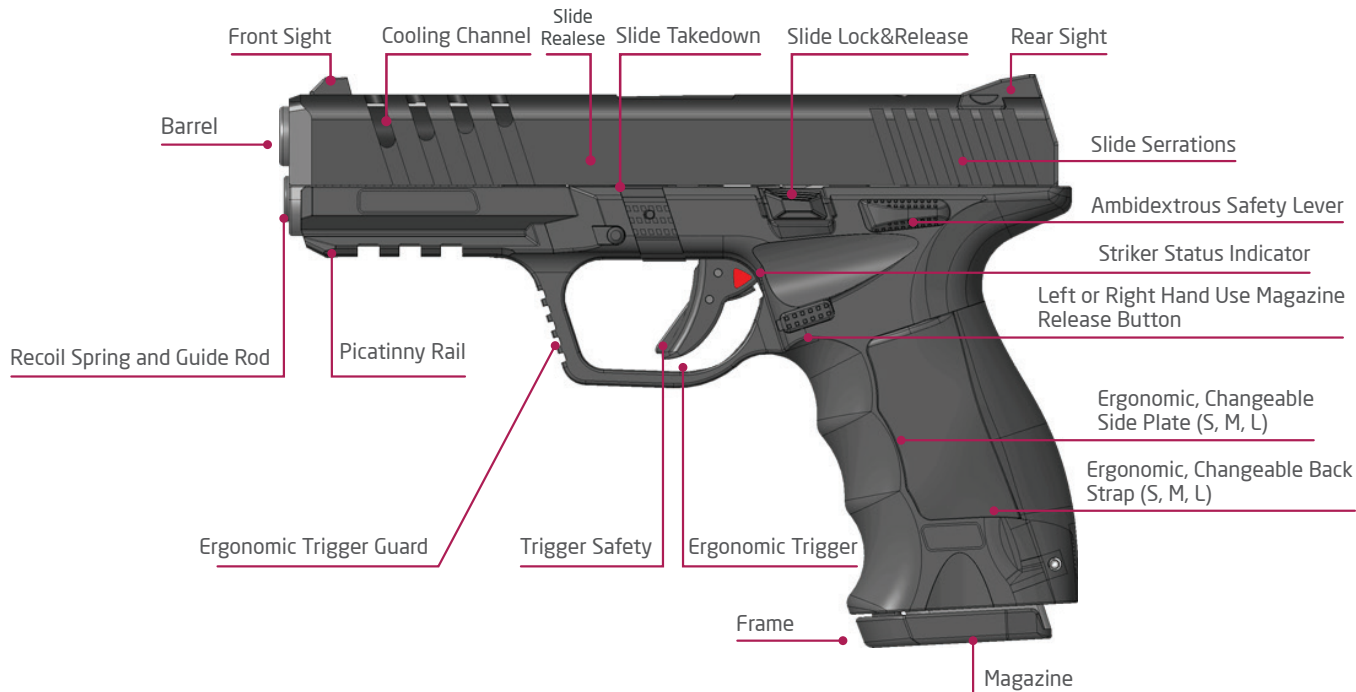

**Note:** SARSILMAZ reserves the right to modify or change the model without any notice.

### 2.4.3. SAR9 SOCOM



**Note:** SARSILMAZ reserves the right to modify or change the model without any notice.

## 2.5. TECHNICAL DATA & FEATURES

	SAR 9	SAR9 T	SAR9 C	SAR9 X
<b>CALIBRE</b>	9x19 mm	9x19 mm	9x19 mm	9x19 mm
<b>OPERATION</b>	Single Action	Single Action	Single Action	Single Action
<b>CAPACITY</b>	17 / 19	17 / 19	15	17 / 19
<b>BARREL LENGTH</b>	4.4" / 113 mm	4.4" / 113 mm	4.0" / 103 mm	4.4" / 113 mm
<b>OVERALL LENGTH</b>	7.6" / 193 mm	7.6" / 193 mm	7.2" / 183 mm	7.6" / 193 mm
<b>HEIGHT</b>	5.5" / 140 mm	5.5" / 140 mm	5.1" / 130 mm	5.5" / 140 mm
<b>WIDTH</b>	1.4" / 37 mm	1.2" / 32 mm	1.2" / 32 mm	1.4" / 37 mm
<b>WEIGHT</b>	27.8 oz / 790 g	27.1 oz / 770 g	26.8 oz / 760 g	27.5 oz / 780 g
<b>BODY</b>	Polymer	Polymer	Polymer	Polymer
<b>SLIDE</b>	Alloyed Forged Steel	Alloyed Forged Steel	Alloyed Forged Steel	Alloyed Forged Steel
<b>BARREL</b>	Alloyed Forged Steel	Alloyed Forged Steel	Alloyed Forged Steel	Alloyed Forged Steel
<b>EXTERNAL SAFETY</b>	√	X	X	√
<b>FIRING PIN SAFETY</b>	√	√	√	√
<b>TRIGGER SAFETY</b>	√	√	√	√
<b>DROP SAFETY</b>	√	√	√	√
<b>REAR SIGHT</b>	Fixed	Fixed	Fixed	Fixed
<b>FRONT SIGHT</b>	Fixed	Fixed	Fixed	Fixed
<b>ACCESSORY RAIL</b>	√	√	√	√
<b>SLIDE VENTING CUTS</b>	X	X	X	√
<b>OPTIC SIGHT</b>	X	X	X	√
<b>WEAPON MOUNTED LIGHT</b>	X	X	X	√
<b>THREADED BARREL</b>	X	X	X	X

	SAR9 CX	SAR9 SPORT	SAR9 METE SAR9 T METE	SAR9 SOCOM
<b>CALIBRE</b>	9x19 mm	9x19 mm	9x19 mm	9x19 mm
<b>OPERATION</b>	Single Action	Single Action	Single Action	Single Action
<b>CAPACITY</b>	15	19	17 / 19	17
<b>BARREL LENGTH</b>	4.0" / 103 mm	5.2" / 133 mm	4.4" / 113 mm	5.0" / 129 mm
<b>OVERALL LENGTH</b>	7.2" / 183 mm	8.3" / 211 mm	7.6" / 193 mm	8.5" / 216 mm
<b>HEIGHT</b>	5.1" / 130 mm	5.9" / 152 mm	5.5" / 140 mm	5.7" / 145 mm
<b>WIDTH</b>	1.2" / 32 mm	1.4" / 37 mm	1.4" / 37 mm	1.4" / 37 mm
<b>WEIGHT</b>	26.8 oz / 760 g	29.9 oz / 850 g	26.4 oz / 750 g	29.1 oz / 825 g
<b>BODY</b>	Polymer	Polymer	Polymer	Polymer
<b>SLIDE</b>	Alloyed Forged Steel	Alloyed Forged Steel	Alloyed Forged Steel	Alloyed Forged Steel
<b>BARREL</b>	Alloyed Forged Steel	Alloyed Forged Steel	Alloyed Forged Steel	Alloyed Forged Steel
<b>EXTERNAL SAFETY</b>	X	X	X	X
<b>FIRING PIN SAFETY</b>	√	√	√	√
<b>TRIGGER SAFETY</b>	√	√	√	√
<b>DROP SAFETY</b>	√	√	√	√
<b>REAR SIGHT</b>	Fixed	Fixed	Fixed	Polymer / High / Fixed
<b>FRONT SIGHT</b>	Fixed	Fixed	Fixed	Polymer / High / Fixed
<b>ACCESSORY RAIL</b>	√	√	√	√
<b>SLIDE VENTING CUTS</b>	√	√	X	√
<b>OPTIC SIGHT</b>	√	√	X	X
<b>WEAPON MOUNTED LIGHT</b>	√	√	X	X
<b>THREADED BARREL</b>	X	X	X	√

## 3. PUTTING YOUR PRODUCT INTO SERVICE

### 3.1. PRELIMINARY PREPERATION

Firearms are generally protected with oil film on it. Before using your firearm, clean your firearm and make sure the barrel doesn't have any excess oil. If there is excess oil, remove it by using a bore mop or patches to push through the barrel.

### 3.2. INSPECTING YOUR FIREARM

- a. If there is a safety lever on your firearm, hold your lever on safety position during inspection. (Figure 1)
- b. Depress the magazine release and remove the magazine. (Figure 2)
- c. Hold your safety lever on firing position if your firearm has a safety lever. (Figure 3)

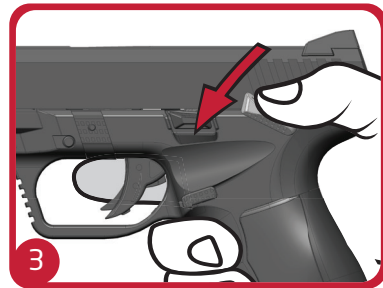
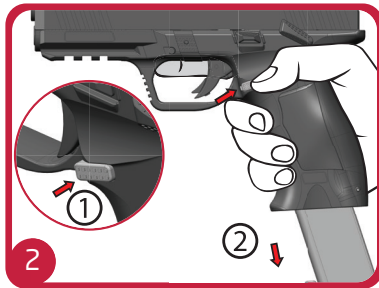
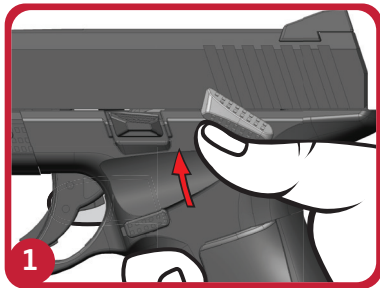

#### **⚠ WARNING**

Safety is only activated when the striker is cocked. Do not try to change the position to safe if not cocked. Forcing the safety into position while not cocked can cause damage which, in turn, will void the warranty.

- d. Pull the slide to the rear, check to see that the chamber is clear and the bore is not obstructed. **(Figure 4)**
- e. Push the manual safety lever to the SAFE position. Pull the trigger while pointing the firearm in a safe direction **(Figure 5)**. **Make sure that the firing pin does not drop.**
- f. Set the safety to FIRE, grip the firearm firmly and pull the trigger. Your firing pin should release during this step.
- g. Move the safety lever to **SAFE** position again.

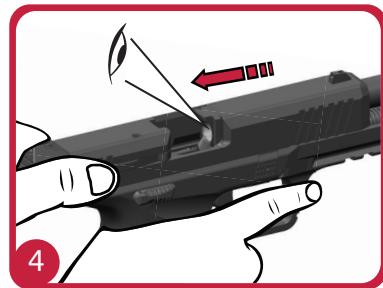

### 3.3. AMMUNITION

- Only use original and high-quality cartridges.
- Cartridges used must be compatible with your firearm's caliber.
- Remember that the hand-loaded or other non-standard cartridges will be excluded from the scope of the warranty.

### 3.4. FIRING

#### 3.4.1. CHECKS AND SAFETY BEFORE FIRING

- Always point the firearm in a safe direction
- Keep your finger off the trigger
- Lock the slide to the rear and check the chamber to see if the firearm is loaded
- Prior to firing, if applicable, wipe off any excess oil from the firearm.
- Do not load and unload your firearm in places not designated for such activity.
- Do not trust the mechanical safety systems of the firearm, make sure to be safe yourself.



### 3.4.2. LOADING YOUR MAGAZINE

- a. Hold the magazine with your non-dominant hand.
- b. With your dominant hand, place a cartridge on the follower in front of the lips, press down and slide the cartridge completely back under the lips.
- c. Repeat until the magazine is fully loaded. **(Figure 6)**

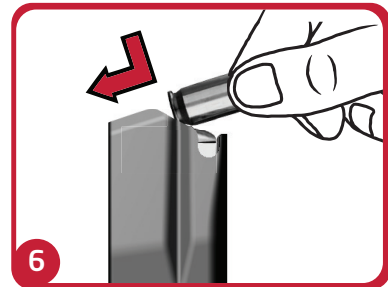

#### **⚠ WARNING**

While loading cartridges, be aware of not damaging magazine lips. Number of cartridges can be observed by holes on the rear side of the magazine. Do not try to force more than maximum indicated rounds into the magazine. Crushed and crooked cartridges can affect the function. Inspect cartridges prior to loading.

### 3.4.3. ASSEMBLING YOUR FIREARM

- a. Make sure your safety is engaged and finger is off the trigger. Push the magazine up into the magazine well until the magazine catch engages and locks the magazine in place. This can be accomplished with the slide locked in the rear position or with the slide in the closed position. **(Figure 7)** Now you can safely insert the magazine directly if your pistol doesn't have a safety lever.
- b. While the slide is closed, pull the slide to the rearward position. Release the slide and allow it to go forward into the close position. The slide will automatically take the cartridge from the magazine and load it into the chamber. If magazine is inserted

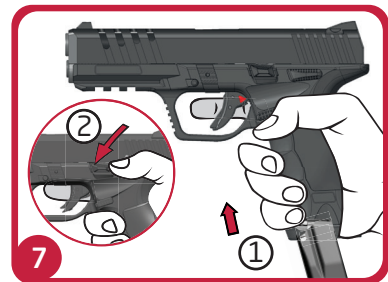

while the slide is locked in the rear position, release the slide by using the slide release or by pulling rearward on the slide and releasing it. Do not allow your hand to follow the slide back. Let it go freely. **(Figure 8)**

- c. The firearm is now loaded and ready to fire. Always remember to keep the muzzle pointed in a safe direction while handling your firearm.
- d. Hold your safety lever on safety position if your firearm has a safety lever.

#### 3.4.4. SETTING YOUR LINE OF FIRE

The proper sight picture can be seen in. **(Figure 9)**

#### **⚠ WARNING**

If you aren't ready to fire, do not feed the chamber with a live ammunition. Also, beware of the slide mechanism sliding to the rear during fire. Do not place your hand on to the travel path of the slide.

#### 3.4.5. FIRING

- Put your finger on the trigger then pull slowly. **(Figure 10)**

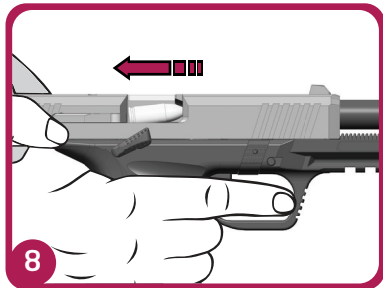





- Do not move from your target/shooting area until you have completed a safety check and made sure firearm is unloaded.
  - When the last round in the magazine is expended, the slide will be locked back in the open position by the slide catch lever.
  - Depress the magazine release button and remove the magazine.
  - Insert a loaded magazine, making sure it is engaged. Then release the slide by; pressing down on the slide catch lever or by pulling back on the slide and release.
- (Figure 11)
- Ensure the firearm is pointed in a safe direction at all times.

### 3.4.6.RELOADING YOUR FIREARM

Check chapters “LOADING THE MAGAZINE” and “LOADING THE FIREARM”.

### 3.4.7. UNLOADING YOUR MAGAZINE

In order to remove cartridges from the magazine, grip the magazine while using your thumb to unload. (Figure 12)

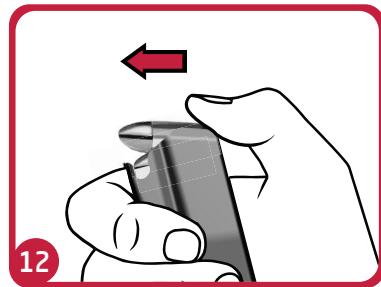

## **3.5.SECURING YOUR FIREARM**

### **3.5.1.UNLOADING YOUR FIREARM**

- The magazine is loaded and one is in the chamber.
- Point the muzzle of the firearm in a safe direction.
- Depress the magazine release and remove the magazine.
- Pulling rearward on the slide will eject the live round from the chamber.
- Rack the slide multiple times to ensure the chamber is empty.
- While the holding the slide in the rearward position, engage the slide release to lock open.
- Visually check the chamber to be sure it is empty.
- By pressing "slide takedown", release the slide.
- Aim your firearm in a safe direction by holding safety lever on firing position if your firearm has a safety lever.

## **4. MAINTENANCE AND CLEANING**

### **4.1. MAINTENANCE AND CLEANING KIT**

Maintenance and Cleaning Kit may contain the following items below:

- Brush x2
- Cleaning Rod
- Protecting Oil

## 4.2. DISASSEMBLING YOUR FIREARM

Understanding about the use and maintenance of your firearm is very important. Many of the shortcomings happen to occur from mistakes made during the gun maintenance. Cleaning, lubrication and protection are necessary and should receive special focus in order for the firearm to work properly and efficiently.

- a. Make sure that the firearm is unloaded and the magazine is removed before disassembling the firearm for cleaning and maintenance.
- b. Visually check to make sure there is no cartridge in the chamber.
- c. Make sure that the firearm points in a safe direction and then pull the trigger.
- d. Push down on the slide takedown. (Figure 13)
  - a. Remove the slide from the frame. (Figure 14)
  - b. Set the frame to the side. Flip slide upside down and removes recoil spring and guide rod assembly (Figure 15)

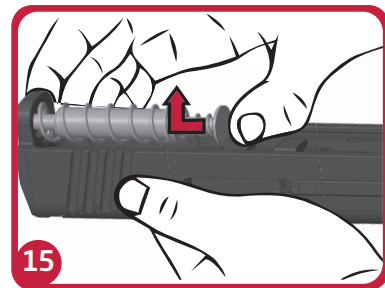
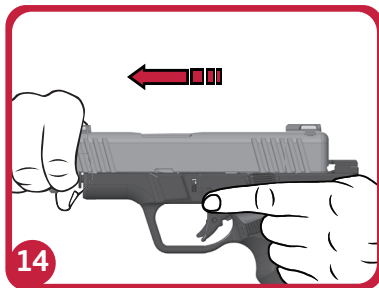
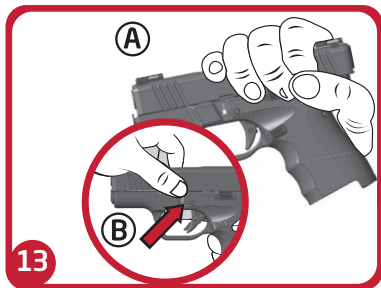

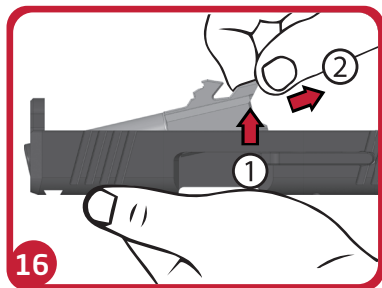

c. Remove the barrel from the cap. **(Figure 16)** Before removing the barrel in the SAR9 SP model, remove the silencer thread guard ring by turning it clockwise (opposite thread). Then remove the barrel from the cap. **(Fig. 16-A)**

**⚠ WARNING**

A basic wipe down of the frame is more than efficient. No further disassembly of the slide or frame is necessary. Any further breakdown should only be completed by allowed/approved gunsmiths.

### 4.3. MAINTENANCE AND CLEANING OF YOUR FIREARM

Be aware that proper cleaning and lubrication is essential for the reliable function, corrosion resistance, accuracy of the firearm and especially for your personal safety. Past experiences have shown that accidents mostly happen at the time of cleaning the firearm. After every use, cleaning and lubrication are recommended (especially the bore, which loses protective oils during firing). Excess oil and grease obstruction in the bore are very dangerous when firing and may cause damages to the firearm and serious injury to the shooter and bystanders. Never spray oil on the cartridges.

Read and follow the manufacturer's warnings before using solvents and cleaners. Remember that you are responsible for the proper care and maintenance of your firearm.

- a. Be sure that the firearm is unloaded.
- b. In order to keep a firearm working properly it must be kept clean and covered with a slight amount of good quality oil to prevent corrosion. This is especially necessary after use.
- c. For cleaning after use it is important that all residues of powder be removed from barrel and other adjacent parts using an appropriate bore brush. If particles of lead are detected in barrel, they must be scrubbed with oil. Once cleaned, lubrication should be done as picture described.
- d. Wipe the slide assembly inside and out with a cloth or brush dampened with cleaning solvent to remove most of the dust and powder fouling. Carefully clean the slide rails as well.

1 Slide



2 Barrel

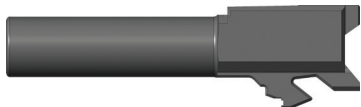

3 Recoil Spring & Rod



4 Frame

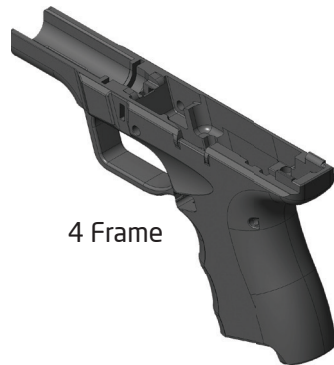

5 Magazine

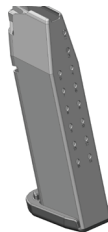

**BARREL: Please clean the barrel as written below**

- a. Clean the barrel with proper cleaning oil with a copper / bronze made brush (steel and bristle brush not recommended) inserting through chamber opening **(Figure 17)**
- b. Inserting through chamber end, clean with cleaning rod and cloth with cleaning oil. **(Figure 17A)**
- c. Inserting cleaning rod and cleaning cloth that is protective oil applied, pass through the chamber end and apply throughout the barrel.
- d. Lubricate the outer surface of barrel with few drops. **(Figure 18)**
- e. Prior to firing, remove excess oil from chamber with a clean cloth.
- f. The use of compressed air to clean the barrel is recommended if available following article "a".

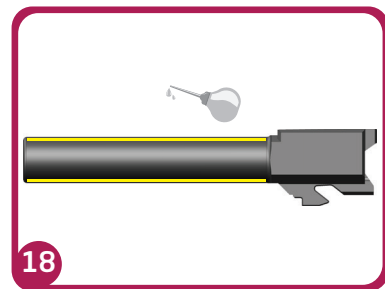
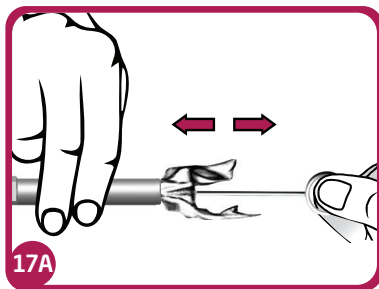
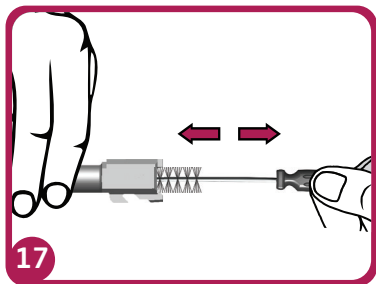

**SLIDE: Clean the slide as described below**

Clean with a plastic made- copper fiber brush with applied cleaning oil or cleaning chemical

- Clean parts such as slide rails and extractor parts to keep slide clear of powder fouling. (Figure 19)
- Apply compressed air if possible and dry with a cloth.
- Lubricate slide channels and joint face with protective oil. (Figure 20)

**⚠ WARNING!**  
**ATTENTION: Please avoid excessive lubricating**

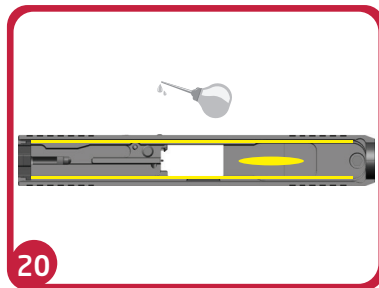
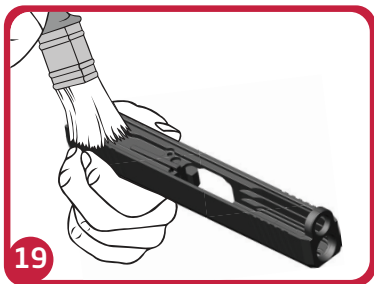

**FRAME: Clean the frame as written below**

- Clean with plastic made brush, plastic made- copper fiber brush, applied of cleaning oil or chemical (gasoline, kerosene, etc.)
- Apply compressed air if possible and dry the frame with a cloth.
- Lubricate guide rails. Lubricate the backside of trigger bar with cleaning oil or grease oil (high viscosity required) **(Figure 21)**

**RECOIL PIN: Clean the recoil pin as written below**

- Clean with plastic made brush, applied to cleaning oil or chemical (gasoline, kerosene, etc.)
- Apply compressed air if possible and use a cleaning cloth.
- Apply protective oil slightly. **(Figure 22)**

**4.4.ASSEMBLING YOUR FIREARM**

- Before installing the barrel in the SAR9 SP model, make sure that the silencer

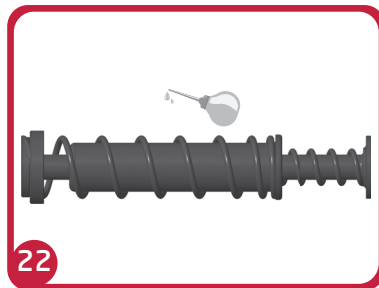
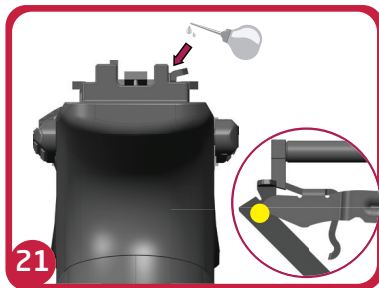



thread guard ring is not attached to the muzzle end. Attach the barrel to the cover in the most backward (locked) position. Then, assemble the muffler thread guard ring to the barrel by turning it counterclockwise (reverse thread). **(Figure 23)**

b. Insert the recoil spring guide assembly into the slide. **(Figure 24)**

c. Guide the slide onto the frame rails from the front. Once the slide is racked in the rearward position a click will indicate the slide takedown is secured in place. **(Figure 25)**

d. Racking the slide of the pistol, check the operation.

e. Check the function of the trigger. Be sure that safety function works properly.

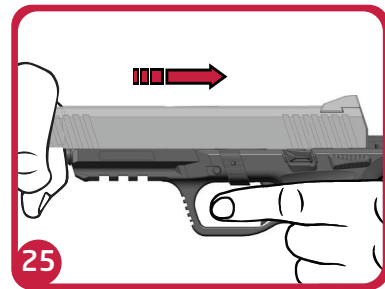
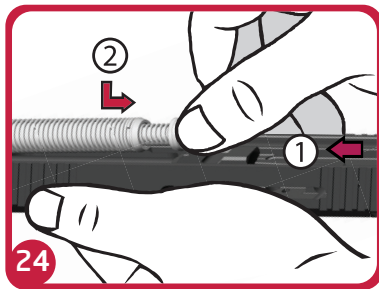
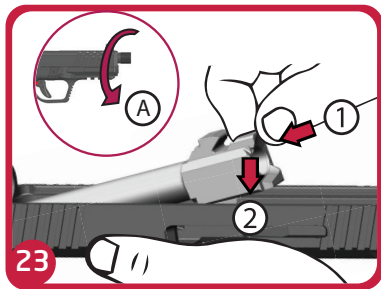

#### 4.5. FUNCTION CHECK

- Following cleaning and maintenance, it is recommended to check the function of the firearm.
- Rack the slide rearwards and release a few times.
- Make sure the slide moves freely. Remember not to ride the slide (pull back and release).
- With safety on safe, pull the trigger in a safe direction. Make sure firing pin does not drop during this process.
- Switch safety to fire; pull the trigger in a safe direction. Make sure firing pin drops during this process.

## 4.6. MAINTENANCE OF YOUR MAGAZINE

### 4.6.1. DISASSEMBLING YOUR MAGAZINE

#### ⚠ **WARNING!**

Make sure to wear safety Goggles and gloves before disassembling the magazine.

- a. Make sure that the magazine is unloaded.
- b. Using a punch or other small rod, press the floor-plate retainer. (Figure 26)
- c. Slide the floor-plate half way. (Figure 27)
- d. Hold the floor-plate retainer ease the floor-plate off the magazine body. Remove floor-plate retainer, magazine Spring, and follower out of the magazine. (Figure 28)

#### ⚠ **WARNING!**

Magazine spring is under tension. Make sure to block off the opening of the magazine after removing the magazine cap to avoid any injury to yourself or those around you. Be sure to wear safety goggles.

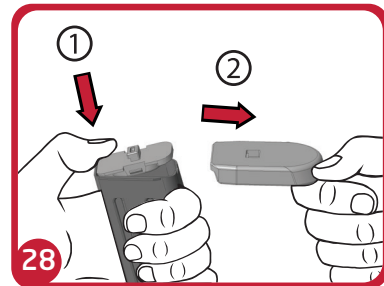
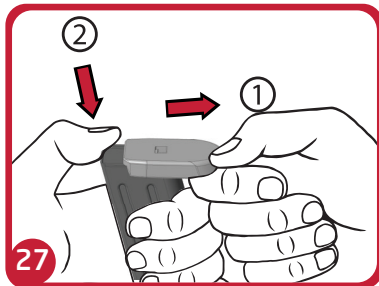
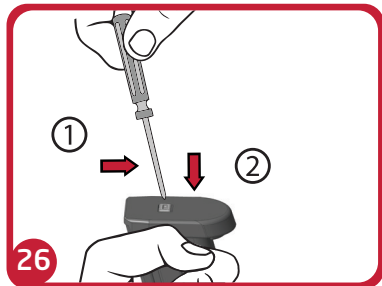

### 4.6.2. CLEANING YOUR MAGAZINE

a. Clean the fouling in the magazine using a bristle brush while moving it lightly inside the magazine up and down. Wipe the outside and inside of the magazine with a clean cloth. **(Figure 29)**

a. Lightly lubricate inside of the magazine using a clean cloth with a couple of drops of oil. **(Figure 30)**

b. It is not necessary to clean your magazine after every use. Only clean if magazine follower is sticking or having feeding issues. If no issues arise, clean at least once every 6 months.

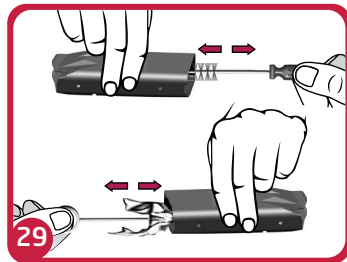

#### ⚠ WARNING

Remember that using harsh solvents/chemicals that are not designed for firearm cleaning will void the warranty.

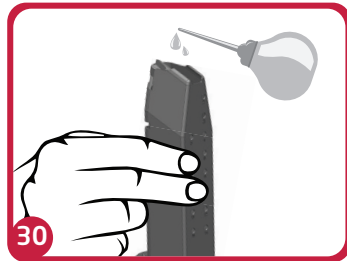

### 4.6.3. ASSEMBLING YOUR MAGAZINE

Assemble in reverse order.

## 4.7. BACK STRAP AND SIDE PLATES DISASSEMBLY

### 4.7.1. REMOVING THE BACK STRAP

- Using the backrest removal pin, remove the backrest pin on the body as shown in the figure. (Figure 31)
- Grasp the backrest shown in Figure - 27 as in the image and pull it back first and then down. (Figure 32)
- Remove the side covers by sliding them backwards as shown in the (Figure 33)

### 4.7.2. SIDE PLATES DISASSEMBLY

### 4.7.3. BACKREST AND COLLECTION OF SIDE CAPS

Assemble the backrest and side covers in reverse order of removal.

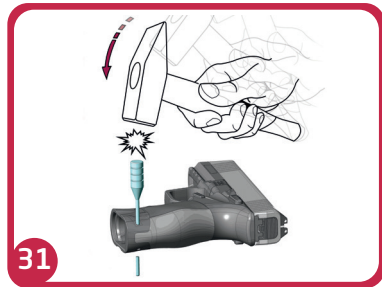

## 4.8. REMOVING FASTENING STANDARD SCREW AND MAGWELL

### FASTENING STANDARD SCREW REMOVAL

- a. Loosen the fastening standard screw with a allen key and unscrew the fastening standard screw. (Figure 34)

### MAGWELL DISASSEMBLY

- a. Remove the magazine funnel by first pulling it downwards from the back as shown in the picture, then free it from the front. (Figure 35)

### ATTACHING FASTENING STANDARD SCREW

- a. Insert the fastening standard screw into the thread. Tighten the fastening standard screw with the hex key. (Figure 36)

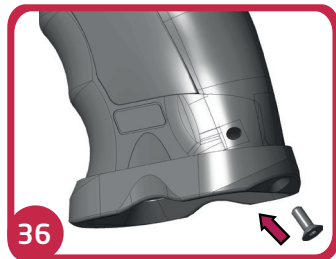
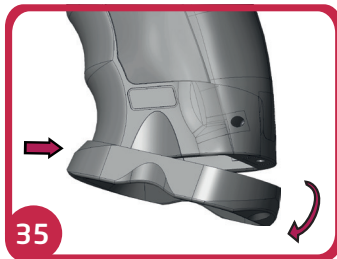
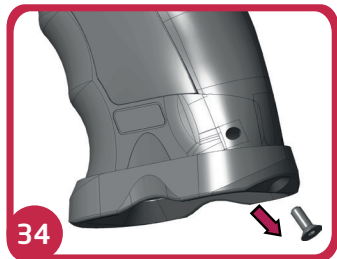

#### 4.9. SILENCER THREAD PROTECTOR DISASSEMBLY AND ASSEMBLY (SAR 9 SOCOM)

- a. Unscrew the muffler thread guard ring by turning it counterclockwise.
- b. Tighten the thread guard by turning it clockwise. (Figure 38)

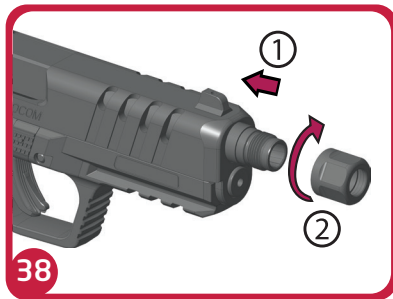
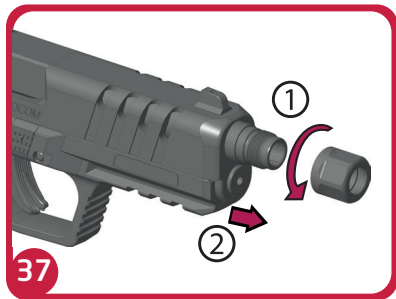

## 5. TROUBLESHOOTING

If your firearm misfires with a live cartridge in the chamber, keep your firearm pointed in a safe direction for at least 10 seconds. Rack the slide to eject the faulty cartridge and continue firing.

The following table outlines the problems and their reasons as well as suggestions with respect to firing		
PROBLEM	REASON	SOLUTION
Cartridge does not fire	Firing pin obstructed	Advise with authorized service agent
	Dirty chamber surface	Unload and clean
	Faulty cartridge	Unload the cartridge from chamber, load new one and continue firing
Cartridge does not feed from magazine into chamber	Magazine not fully seated into magwell	Push the magazine up with your palm. Make sure to hear a "click" to ensure the magazine is fully seated
	Faulty Magazine	Replace the magazine
	Dirty Magazine	Unload the cartridges and clean the magazine
	Faulty inserted magazine	Remove the magazine and inspect. Reinsert the magazine properly
Spent cartridge not ejecting	Under pressured load	Eject magazine. Rack the slide while tilting ejection port side to the right. Sometimes a slight shake will allow spent cartridges to fall free. If the problem persists, advise with authorized/approved gunsmith
	Cartridge extractor damaged	Advise with authorized/approved gunsmith
	Extractor is stuck	Advise with authorized/approved gunsmith

## **6. EXPLODED VIEW and PART LIST**



## 6.1. SAR9 - SAR9 T - SAR9 METE - SAR9 T METE EXPLODED WIEV

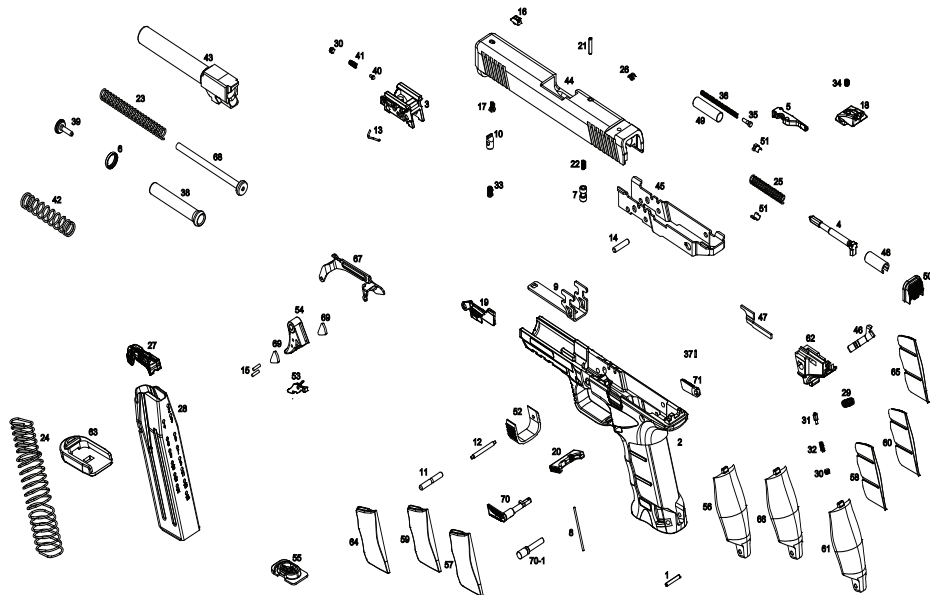

**Note:** Sarsilmaz reserves the right to make an amendment or in line change on features without notice when it is needed .

**Warning:** Parts of SAR 9, SAR 9T, SAR 9 METE and SAR 9T METE are all the same, Numbered part as of 70-1 only belongs to SAR 9T and SAR 9T METE, numbered parts as of 37-70-71 only belong to SAR 9 and SAR 9 METE

## SAR9 - SAR9 T - SAR9 METE SAR9 T METE PART LIST

NO	PART NAME	NO	PART NAME	NO	PART NAME
1	PIN	27	FOLLOWER	53	TRIGGER SAFETY
2	FRAME	28	MAGAZINE	54	TRIGGER
3	LOCKING BLOG	29	TRIGGER SPRING	55	MAGAZINE BUTTPLATE CATCH
4	FIRING PIN	30	M4 STOPPER	56	BACK GRIP PANEL-L
5	EXTRACTOR	31	PLUNGER	57	LEFT GRIP PANEL-M
6	MAIN SPRING CUP	32	PLUNGER SPRING	58	RIGHT GRIP PANEL-M
7	FIRING PIN SAFETY	33	SLIDE LOCK SPRING	59	LEFT GRIP PANEL-S
8	MAGAZINE CATCH SPRING	34	M4X8 SETSKUR	60	RIGHT GRIP PANEL-S
9	STEEL SUPPORT	35	SLIDE COVER PLATE PLUNGER	61	BACK GRIP PANEL-S
10	SLIDE LOCK BLOCK	36	SLIDE COVER PLATE PLUNGER SPRING	62	SEAR HOUSING
11	LOCKING BLOCK PIN	37	SAFETY LEVER PIN	63	MAGAZINE
12	SLIDE LOCK PIN	38	RECOIL SPRING CUP	64	LEFT GRIP PANEL-L
13	SLIDE SROP LEVER SPRING	39	STOPPER	65	RIGHT GRIP PANEL-L
14	TRIGGER PIN	40	LOCKING BLOCK PLUNGER	66	BACK GRIP PANEL-M
15	TRIGGER SAFETY PIN	41	LOCKING BLOCK PLUNGER SPRING	67	TRIGGER BAR
16	FRONT SIGHT	42	MAIN RECOIL SPRING	68	RECOIL SPRING GUIDE ROD
17	FRONT SIGHT SCREW	43	BARREL	69	INDICATOR
18	REAR SIGHT	44	SLIDE	70	SAFETY LEVER (LEFT)
19	SLIDE STOP LEVER	45	GRIP MODULE	70-1	SEAR HOUSING PIN
20	MAGAZINE CATCH	46	CONNECTOR	71	SAFETY LEVER (RIGHT)
21	PIN	47	EJECTOR		
22	FRING PIN SAFETY SPRING	48	SPACER SLEEVE		
23	SECOND RECOIL SPRING	49	CUP		
24	MAGAZINE SPRING	50	SLIDE COVER PLATE		
25	FIRING PIN SPRING	51	SPRING CUPS		
26	EXTRACTOR SPRING	52	SLIDE LOCK		

**Warning:** Parts of SAR 9, SAR 9T, SAR 9 METE and SAR 9T METE are all the same, Numbered part as of 70-1 only belongs to SAR 9T and SAR 9T METE, numbered parts as of 37-70-71 only belong to SAR 9 and SAR 9 METE

## 6.2. SAR9 X EXPLODED VIEW

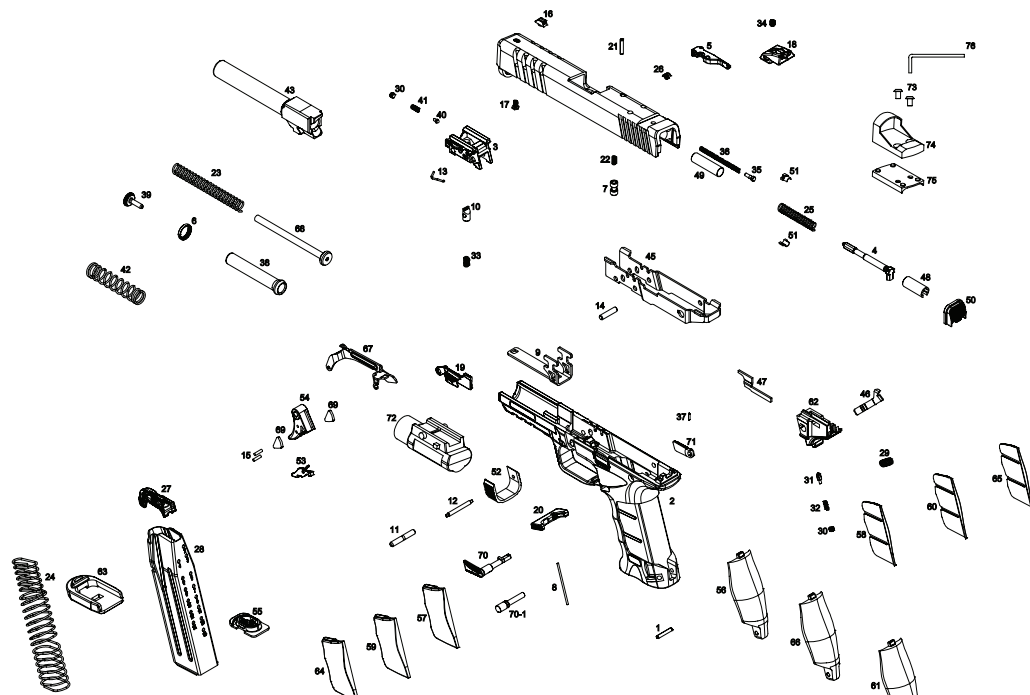

**Note:** Sarsilmaz reserves the right to make an amendment or in line change on features without notice when it is needed.

## SAR9 X PART LIST

## NO PART NAME

1	PIN
2	FRAME
3	LOCKING BLOG
4	FIRING PIN
5	EXTRACTOR
6	MAIN SPRING CUP
7	FIRING PIN SAFETY
8	MAGAZINE CATCH SPRING
9	STEEL SUPPORT
10	SLIDE LOCK BLOCK
11	LOCKING BLOCK PIN
12	SLIDE LOCK PIN
13	SLIDE SROP LEVER SPRING
14	TRIGGER PIN
15	TRIGGER SAFETY PIN
16	FRONT SIGHT
17	FRONT SIGHT SCREW
18	REAR SIGHT
19	SLIDE STOP LEVER
20	MAGAZINE CATCH
21	PIN
22	FRING PIN SAFETY SPRING
23	SECOND RECOIL SPRING
24	MAGAZINE SPRING
25	FIRING PIN SPRING
26	EXTRACTOR SPRING

## NO PART NAME

27	FOLLOWER
28	MAGAZINE
29	TRIGGER SPRING
30	M4 STOPPER
31	PLUNGER
32	PLUNGER SPRING
33	SLIDE LOCK SPRING
34	M4X8 SETSKUR
35	SLIDE COVER PLATE PLUNGER
36	SLIDE COVER PLATE PLUNGER SPRING
37	SAFETY LEVER PIN
38	RECOIL SPRING CUP
39	STOPPER
40	LOCKING BLOCK PLUNGER
41	LOCKING BLOCK PLUNGER SPRING
42	MAIN RECOIL SPRING
43	BARREL
44	SLIDE
45	GRIP MODULE
46	CONNECTOR
47	EJECTOR
48	SPACER SLEEVE
49	CUP
50	SLIDE COVER PLATE
51	SPRING CUPS
52	SLIDE LOCK

## NO PART NAME

53	TRIGGER SAFETY
54	TRIGGER
55	MAGAZINE BUTTPLATE CATCH
56	BACK GRIP PANEL-L
57	LEFT GRIP PANEL-M
58	RIGHT GRIP PANEL-M
59	LEFT GRIP PANEL-S
60	RIGHT GRIP PANEL_S
61	BACK GRIP PANEL-S
62	SEAR HOUSING
63	MAGAZINE
64	LEFT GRIP PANEL-L
65	RIGHT GRIP PANEL-L
66	BACK GRIP PANEL-M
67	TRIGGER BAR
68	RECOIL SPRING GUIDE ROD
69	INDICATOR
70	SAFETY LEVER (LEFT)
71	SAFETY LEVER (RIGHT)
72	FLASH LIGHT
73	M4 RED DOT MOUNTING SCREW
74	RED DOT SIGHT
75	RED DOT MOUNTING PLATE
76	ALLEN KEY

### 6.3. SAR9 C EXPLODED WIEV

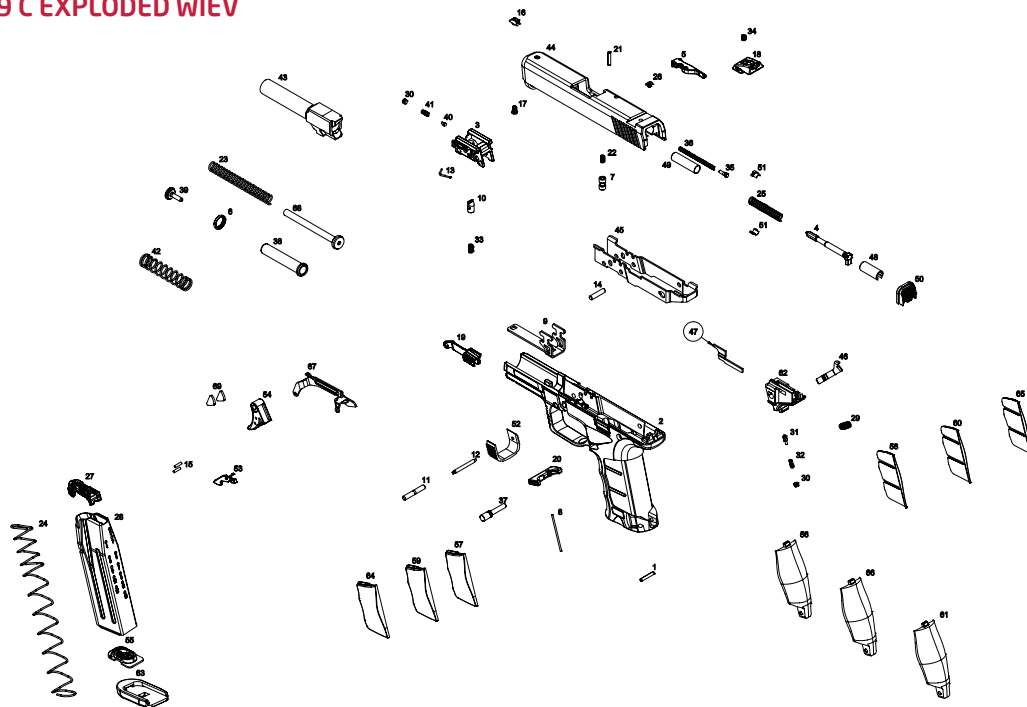

**Note:** Sarsilmaz reserves the right to make an amendment or in line change on features without notice when it is needed.

## SAR9 C PART LIST

## NO PART NAME

1	PIN
2	FRAME
3	LOCKING BLOG
4	FIRING PIN
5	EXTRACTOR
6	MAIN SPRING CUP
7	FIRING PIN SAFETY
8	MAGAZINE CATCH SPRING
9	STEEL SUPPORT
10	SLIDE LOCK BLOCK
11	LOCKING BLOCK PIN
12	SLIDE LOCK PIN
13	SLIDE SROP LEVER SPRING
14	TRIGGER PIN
15	TRIGGER SAFETY PIN
16	FRONT SIGHT
17	FRONT SIGHT SCREW
18	REAR SIGHT
19	SLIDE STOP LEVER
20	MAGAZINE CATCH
21	PIN
22	FRING PIN SAFETY SPRING
23	SECOND RECOIL SPRING
24	MAGAZINE SPRING
25	FIRING PIN SPRING

## NO PART NAME

26	EXTRACTOR SPRING
27	FOLLOWER
28	MAGAZINE
29	TRIGGER SPRING
30	M4 STOPPER
31	PLUNGER
32	PLUNGER SPRING
33	SLIDE LOCK SPRING
34	M4X8 SETSKUR
35	SLIDE COVER PLATE PLUNGER
36	SLIDE COVER PLATE PLUNGER SPRING
37	SEAR HOUSING PIN
38	RECOIL SPRING CUP
39	STOPPER
40	LOCKING BLOCK PLUNGER
41	LOCKING BLOCK PLUNGER SPRING
42	MAIN RECOIL SPRING
43	BARREL
44	SLIDE
45	GRIP MODULE
46	CONNECTOR
47	EJECTOR
48	SPACER SLEEVE
49	CUP
50	SLIDE COVER PLATE

## NO PART NAME

51	SPRING CUPS
52	SLIDE LOCK
53	TRIGGER SAFETY
54	TRIGGER
55	MAGAZINE BUTTPLATE CATCH
56	BACK GRIP PANEL-L
57	LEFT GRIP PANEL-M
58	RIGHT GRIP PANEL-M
59	LEFT GRIP PANEL-S
60	RIGHT GRIP PANEL_S
61	BACK GRIP PANEL-S
62	SEAR HOUSING
63	MAGAZINE
64	LEFT GRIP PANEL-L
65	RIGHT GRIP PANEL-L
66	BACK GRIP PANEL-M
67	TRIGGER BAR
68	RECOIL SPRING GUIDE ROD
69	INDICATOR

## 6.4. SAR9 CX EXPLODED VIEW

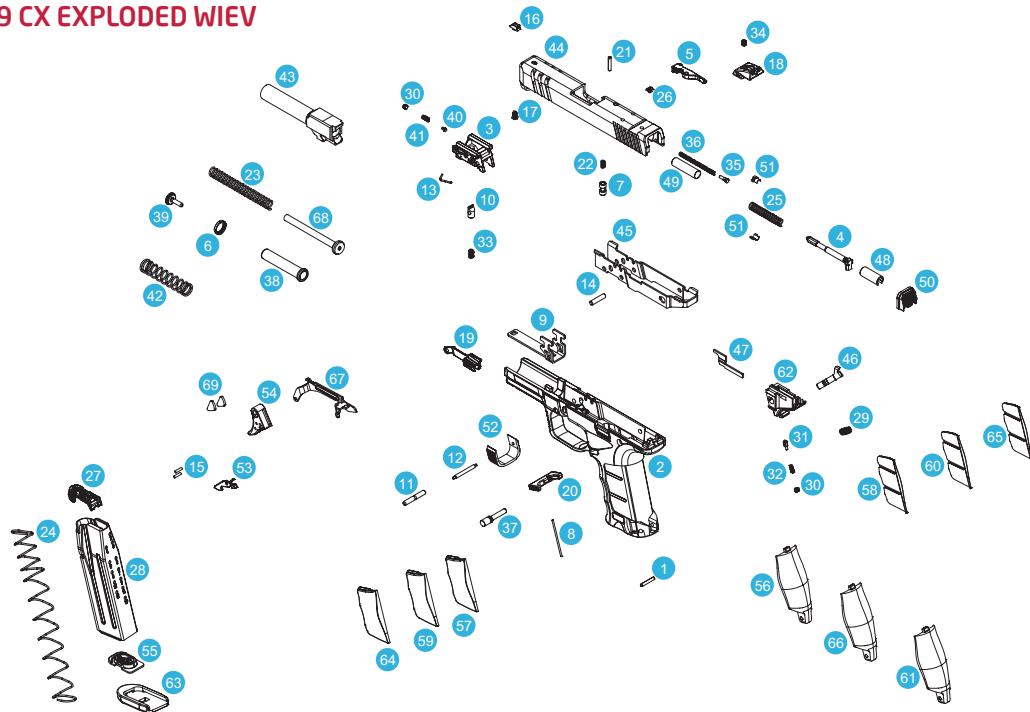

**Note:** Sarsilmaz reserves the right to make an amendment or in line change on features without notice when it is needed.

## SAR9 CX PART LIST

## NO PART NAME

1	PIN
2	FRAME
3	LOCKING BLOG
4	FIRING PIN
5	EXTRACTOR
6	MAIN SPRING CUP
7	FIRING PIN SAFETY
8	MAGAZINE CATCH SPRING
9	STEEL SUPPORT
10	SLIDE LOCK BLOCK
11	LOCKING BLOCK PIN
12	SLIDE LOCK PIN
13	SLIDE SROP LEVER SPRING
14	TRIGGER PIN
15	TRIGGER SAFETY PIN
16	FRONT SIGHT
17	FRONT SIGHT SCREW
18	REAR SIGHT
19	SLIDE STOP LEVER
20	MAGAZINE CATCH
21	PIN
22	FRING PIN SAFETY SPRING
23	SECOND RECOIL SPRING
24	MAGAZINE SPRING
25	FIRING PIN SPRING
26	EXTRACTOR SPRING

## NO PART NAME

27	FOLLOWER
28	MAGAZINE
29	TRIGGER SPRING
30	M4 STOPPER
31	PLUNGER
32	PLUNGER SPRING
33	SLIDE LOCK SPRING
34	M4X8 SETSKUR
35	SLIDE COVER PLATE PLUNGER
36	SLIDE COVER PLATE PLUNGER SPRING
37	SEAR HOUSING PIN
38	RECOIL SPRING CUP
39	STOPPER
40	LOCKING BLOCK PLUNGER
41	LOCKING BLOCK PLUNGER SPRING
42	MAIN RECOIL SPRING
43	BARREL
44	SLIDE
45	GRIP MODULE
46	CONNECTOR
47	EJECTOR
48	SPACER SLEEVE
49	CUP
50	SLIDE COVER PLATE
51	SPRING CUPS
52	SLIDE LOCK

## NO PART NAME

53	TRIGGER SAFETY
54	TRIGGER
55	MAGAZINE BUTTPLATE CATCH
56	BACK GRIP PANEL-L
57	LEFT GRIP PANEL-M
58	RIGHT GRIP PANEL-M
59	LEFT GRIP PANEL-S
60	RIGHT GRIP PANEL_S
61	BACK GRIP PANEL-S
62	SEAR HOUSING
63	MAGAZINE
64	LEFT GRIP PANEL-L
65	RIGHT GRIP PANEL-L
66	BACK GRIP PANEL-M
67	TRIGGER BAR
68	RECOIL SPRING GUIDE ROD
69	INDICATOR



## 6.5. SAR9 SPORT EXPLODED VIEW

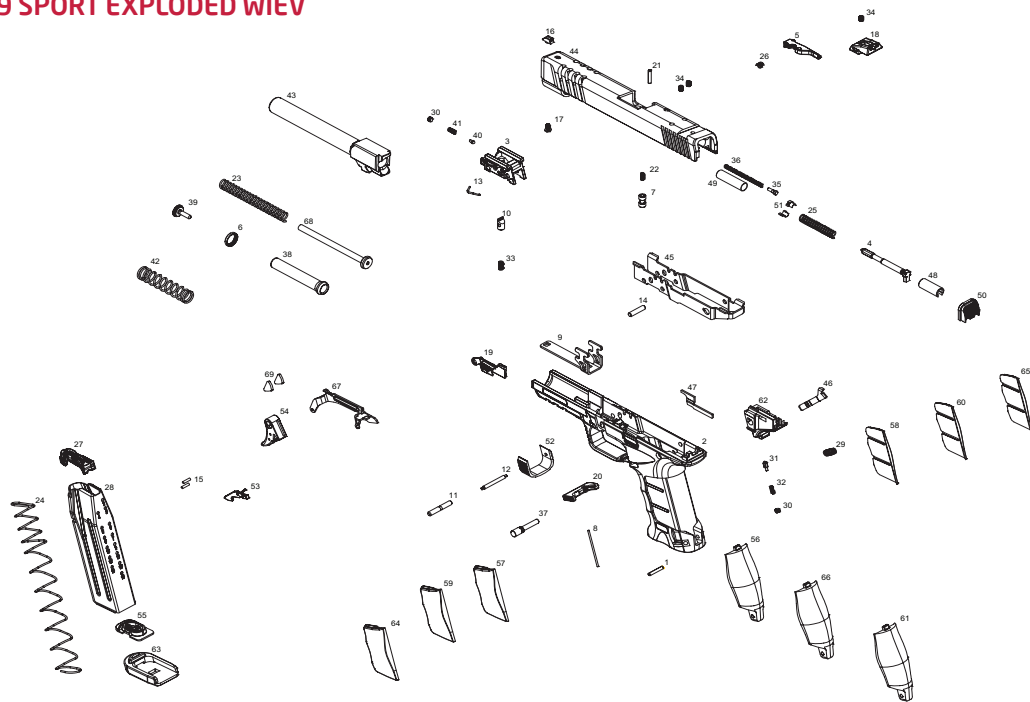

**Note:** Sarsilmaz reserves the right to make an amendment or in line change on features without notice when it is needed.

## SAR9 SPORT PART LIST

## NO PART NAME

1	PIN
2	FRAME
3	LOCKING BLOG
4	FIRING PIN
5	EXTRACTOR
6	MAIN SPRING CUP
7	FIRING PIN SAFETY
8	MAGAZINE CATCH SPRING
9	STEEL SUPPORT
10	SLIDE LOCK BLOCK
11	LOCKING BLOCK PIN
12	SLIDE LOCK PIN
13	SLIDE SROP LEVER SPRING
14	TRIGGER PIN
15	TRIGGER SAFETY PIN
16	FRONT SIGHT
17	FRONT SIGHT SCREW
18	REAR SIGHT
19	SLIDE STOP LEVER
20	MAGAZINE CATCH
21	PIN
22	FRING PIN SAFETY SPRING
23	SECOND RECOIL SPRING
24	MAGAZINE SPRING
25	FIRING PIN SPRING

## NO PART NAME

26	EXTRACTOR SPRING
27	FOLLOWER
28	MAGAZINE
29	TRIGGER SPRING
30	M4 STOPPER
31	PLUNGER
32	PLUNGER SPRING
33	SLIDE LOCK SPRING
34	M4X8 SETSKUR
35	SLIDE COVER PLATE PLUNGER
36	SLIDE COVER PLATE PLUNGER SPRING
37	SEAR HOUSING PIN
38	RECOIL SPRING CUP
39	STOPPER
40	LOCKING BLOCK PLUNGER
41	LOCKING BLOCK PLUNGER SPRING
42	MAIN RECOIL SPRING
43	BARREL
44	SLIDE
45	GRIP MODULE
46	CONNECTOR
47	EJECTOR
48	SPACER SLEEVE
49	CUP
50	SLIDE COVER PLATE

## NO PART NAME

51	SPRING CUPS
52	SLIDE LOCK
53	TRIGGER SAFETY
54	TRIGGER
55	MAGAZINE BUTTPLATE CATCH
56	BACK GRIP PANEL-L
57	LEFT GRIP PANEL-M
58	RIGHT GRIP PANEL-M
59	LEFT GRIP PANEL-S
60	RIGHT GRIP PANEL_S
61	BACK GRIP PANEL-S
62	SEAR HOUSING
63	MAGAZINE
64	LEFT GRIP PANEL-L
65	RIGHT GRIP PANEL-L
66	BACK GRIP PANEL-M
67	TRIGGER BAR
68	RECOIL SPRING GUIDE ROD
69	INDICATOR

## 6.6.SAR9 SPORT EXPLODED WIEV

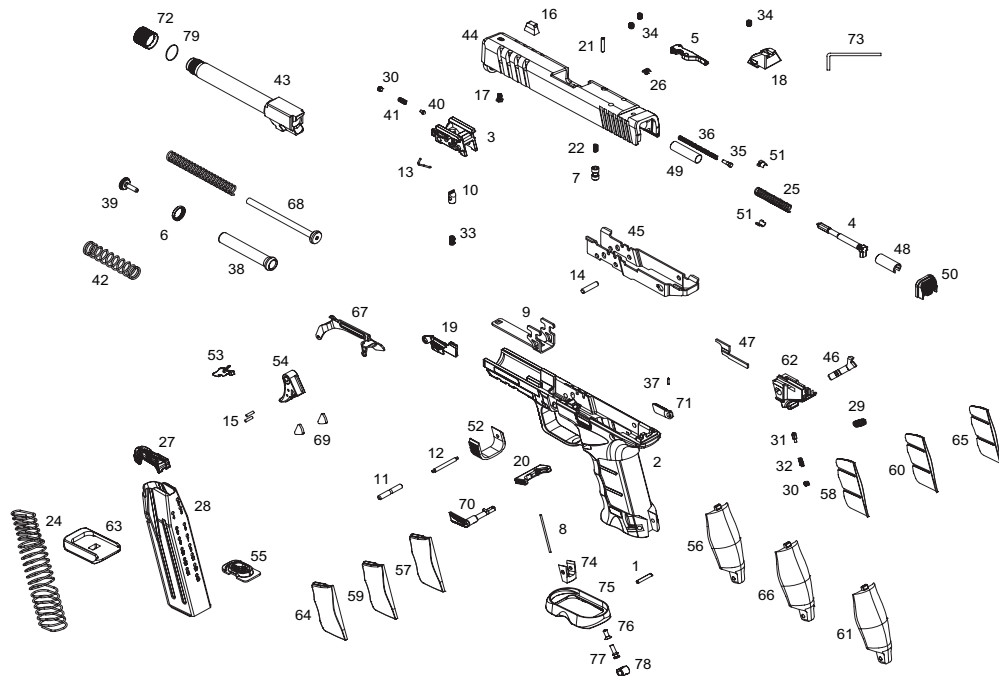

**Note:** Sarsilmaz reserves the right to make an amendment or in line change on features without notice when it is needed.

**SAR9 SOCOM****NO PART NAME**

1. FRAME
2. LEFT GRIP PANEL - M
3. RIGHT GRIP PANEL - M
4. BACK GRIP PANEL - M
5. MAGWELL CONNECTOR
6. BACKGRIP PIN
7. MAGWELL
8. MAGWELL SCREW
9. STEEL SUPPORT
10. MAGAZINE CATCH
11. MAGAZINE CATCH SPRING
12. GRIP MODULE
13. LOCKING BLOCK
14. LOCKING BLOCK PIN PLUNGER
15. LOCKING BLOCK PIN PLUNGER SPRING
16. LOCKING BLOCK PIN
17. M4 STOPPER
18. SLIDE LOCK BLOCK
19. SLIDE LOCK SPRING
20. SLIDE LOCK PIN
21. SLIDE LOCK
22. SEAR HOUSING
23. EJECTOR
24. SEAR HOUSING PIN
25. PLUNGER
26. PLUNGER SPRING

**NO PART NAME**

27. M4 STOPPER
28. TRIGGER SPRING
29. CONNECTOR
30. SLIDE STOP LEVER
31. SLIDE STOP LEVER SPRING
32. TRIGGER PIN
33. TRIGGER
34. TRIGGER SAFETY
35. TRIGGER SAFETY SPRING
36. TRIGGER PIN
37. TRIGGER PIN
38. TRIGGER BAR
39. MAGAZINE BODY
40. FOLLOWER
41. MAGAZINE SPRING
42. MAGAZINE BUTTPLATE
43. MAGAZINE BUTTPLATE CATCH
44. SLIDE
45. FRONT SIGHT
46. FRONT SIGHT SCREW
47. REAR SIGHT
48. EXTRACTOR SPRING
49. EXTRACTOR
50. EXTRACTOR PIN
51. CUP
52. FIRING PIN

**NO PART NAME**

53. SPACER SLEEVE
54. FIRING PIN SPRING
55. SPRING CUPS
56. SPRING CUPS
57. FIRING PIN SAFETY
58. FIRING PIN SAFETY SPRING
59. SLIDE COVER PLATE
60. SLIDE COVER PLATE SHEET METAL
61. SLIDE COVER PLATE PLUNGER SPRING
62. SLIDE COVER PLATE PLUNGER
63. BARREL
64. MUFFLER THREAD GUARD
65. HOLOGRAPHIC SIGHT COVER
66. RECOIL SPRING GUIDE ROD
67. RECOIL ROD WASHER
68. RECOIL SPRING CUP
69. STOPPER
70. SECOND RECOIL SPRING
71. MAIN RECOIL SPRING
72. SCREW
73. SCREW

## 6.7. SAR9 SOCOM EXPLODED VIEW

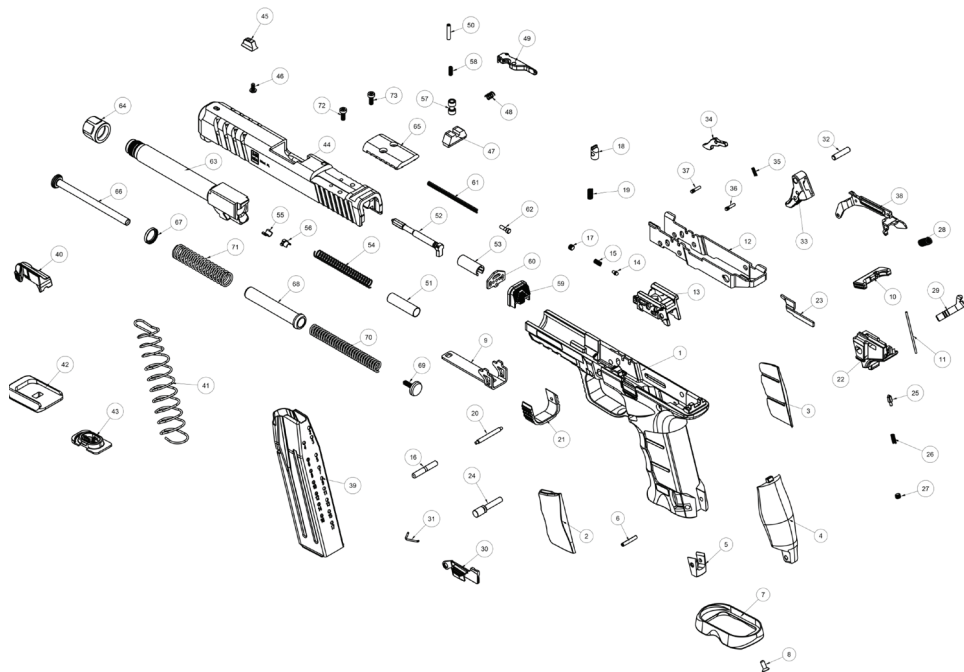

**Note:** Sarsilmaz reserves the right to make an amendment or in line change on features without notice when it is needed.

*NOT*



# SAR

1-833-SAR-GUNS

1-833-727-4867

**sarusa.com**